

Jensen Sentry System Seal Change Procedure

Jensen's dual purpose Lubrication\Detection System is designed to provide lubrication to the Seal area and provide a visual notification of a Seal failure.

1. Determine the condition of your system.

Leak Detection Glass. 
If product is visible a leak is present.

Lubrication Level Glass. 
Fill with lubrication until visible in this glass.

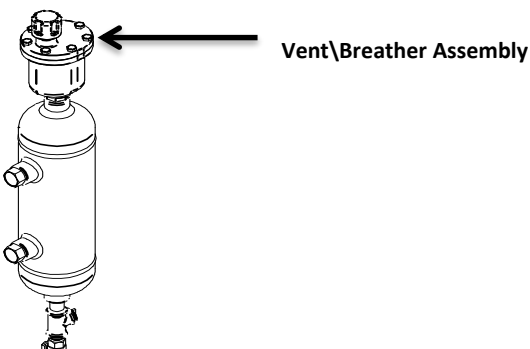

2. Drain Reservoir by removing plug and lowering the release valve handle.

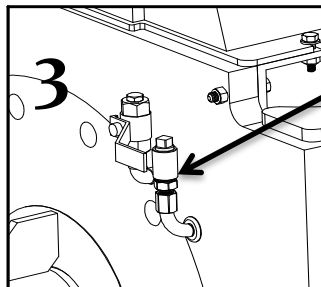
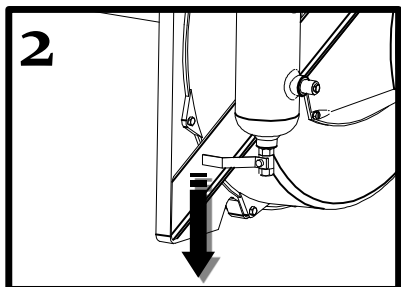

3. Remove Vent Plug in front of Cover Plate.

4. Remove Yoke Cover and 8 yoke bolts. Put "Pull Lock" in vertical position. **NOTE:** Procedure will be aided by removal of all covers.

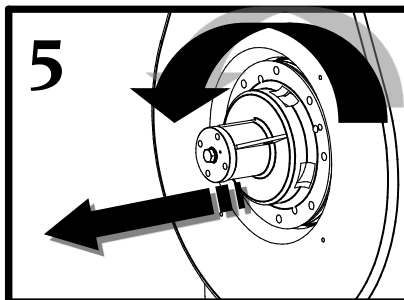
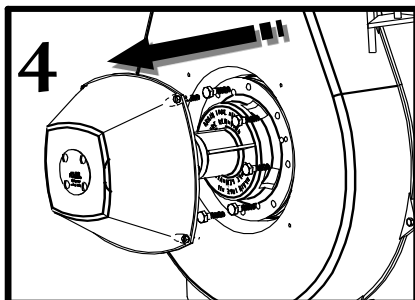

5. Perform Lock-off by pulling the Yoke back to stop (Approximately 1/2" to 1"). Then turn counter-clockwise until shaft stops (90° or more). Tank will be sealed off.

6. Remove Center Shaft Bolt and Shaft Key.

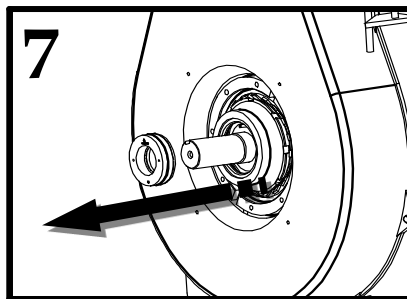
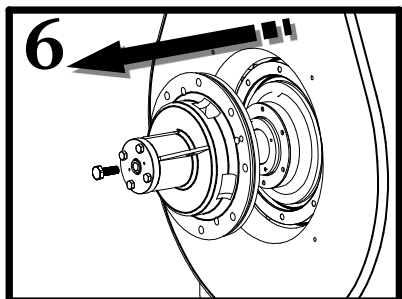

7. Remove Drive Ring. (A solid pull by hand will generally be sufficient.) 2, 1/4-20 tapped holes are provided to aid in removal. **NOTE:** Use Caution to avoid damaging Lip Seal

8. Locate locked Tab and pry up clearing the retaining nut.

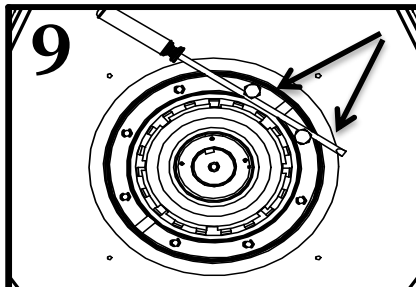
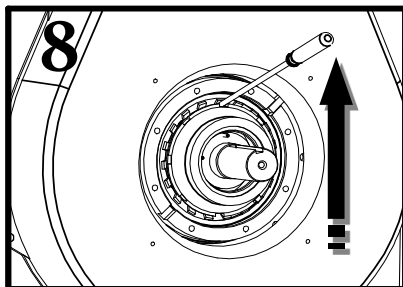

9. Partially thread in 2 yoke bolts (shown with arrows) to aid in turning Hub to line up the notches in Retaining Nut. (**NOTE:** if strap-wrench is available skip to step 12)

10.

Align Hub Notch with 1 of 8 notches in Retaining Nut.

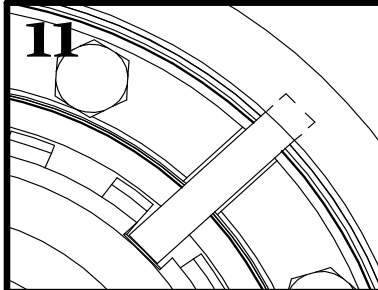
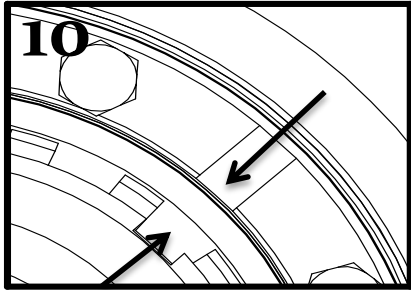

11.

Install Drive Key under Pulley Cover and slide into the Hub notch and Retaining Nut notch.
NOTE: Take care not to drop key into cover

12.

With Key engaged to Hub and Retaining Nut, turn counter-clockwise to break Retaining nut loose. Finish removal of Retaining Nut by hand.

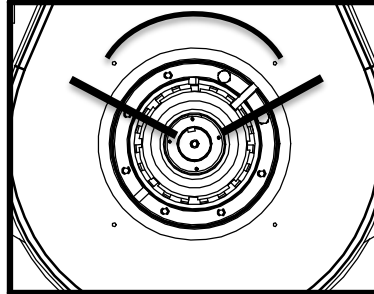
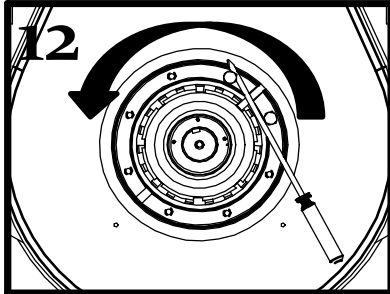

NOTE: When Key is engaged to Hub and Retaining Nut keep Key between 10 o'clock and 2 o'clock positions to alleviate the possibility of Key falling into Cover. **Be sure Key is not engaged in the Lock Washer. This will impede the ability to turn Locking Nut.**

13.

Remove Retaining Nut and Seal. Replace with new Seal. Replace Drive Ring and Retaining Nut.

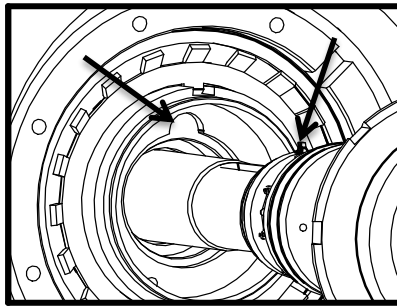
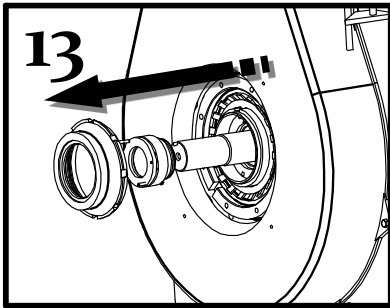

NOTE:

When replacing Seal be sure to align Seal Tab with Pocket

14.

Tighten Retaining nut using the Drive Key\ Bolts method shown in steps 8-11. Tighten only until the Lock-Washer cannot be moved by hand and one of the notches in Retaining Ring are lined up with a tab from Lock-Washer.

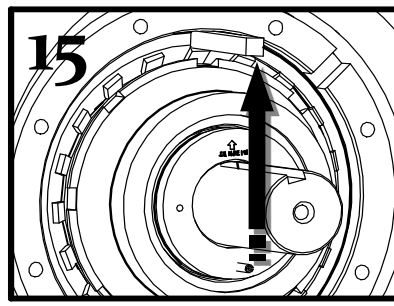
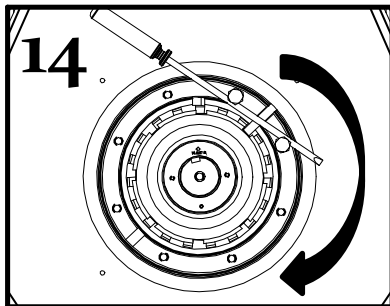

15.

Placing Drive Key between Hub and Lock Washer Tab, drive the Key in an upwards direction (Light tapping with a hammer). This will drive the Tab down, locking the Retaining nut in place. (**NOTE: Take care not to damage Bearing.**)

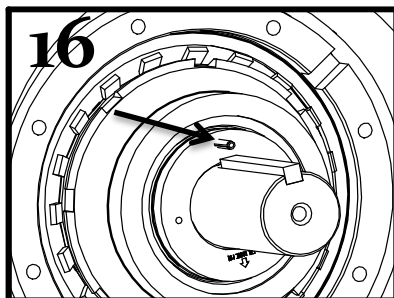

16.

Turn Drive Ring to align Drive Pin with Drive Key. Replace Drive Key. Reverse steps 6-2, refill Reservoir and replace Vent Plug to complete the process.